

# **LANKOTA HEADER TRAILER**

## **Owner's Manual**



**LANKOTA Inc.  
270 West Park Ave.  
Huron, SD 57350  
Phone: 1-866-526-5682  
Fax: 1-605-352-2927**

# TABLE OF CONTENTS

TABLE OF CONTENTS .....	2
TRAILER INFORMATIONAL PLACARD .....	3
LIMITED WARRANTY .....	4
OPERATOR QUALIFICATIONS .....	5
MACHINE INSPECTION .....	6
TIRE SAFETY .....	6
LUBRICATION & MAINTENANCE .....	6
TRAILER WIRING DIAGRAM .....	7
FRONT BRAKE CONNECT/DISCONNECT FEATURE .....	7
OPERATING PROCEDURES .....	9
HIGHWAY & TRANSPORT OPERATIONS .....	9

**Purpose:**

The LANKOTA Header Trailer is used to transport many different combine heads to and from the work area.

**Features:**

1. Frame – Rugged built mono-beam design.
2. Telescoping tongue - A telescoping tongue that allows easy hook up.
3. Light kit and breaks meeting D.O.T. standards.
4. Rated for highway speeds.
5. Adjustable brackets to fit most heads.

Thank you for choosing the LANKOTA Combine Header Trailer. This manual covers the operation and maintenance of the LANKOTA Combine Header Trailer. All information in this manual is based on the latest production information available at the time of printing. For the latest version of this catalog please call 1-866-526-5682.

LANKOTA Inc. reserves the right to make changes at any time without notice and without incurring any obligation.

Please become familiar with all safety, operating, maintenance and troubleshooting information. This will ensure your safety and long life for the system.

**Trailer Informational Placard**

A placard with information regarding specific trailer specifications including the V.I.N. can be found on the back side of the front tricycle dolly assembly just above the main beam of the trailer as shown below.



## **LANKOTA INC.**

### **LIMITED WARRANTY**

#### **TO THE DEALER:**

- Read manual instructions and safety rules.
- Make sure all items on the Dealer's Delivery List are complete before releasing equipment to the owner.

LANKOTA Inc. warrants all products manufactured by it to be free of defect in material and workmanship for a period of one (1) year from the date of purchase.

This LANKOTA Inc. warranty does not cover:

1. Parts and accessories supplied by LANKOTA Inc. but manufactured by others. LANKOTA Inc. will facilitate the other manufacturer warranty for the benefit of the purchaser but will not be bound thereby.
2. Malfunctions or damages to the product from misuse, negligence, customer alteration, accidents or product abuse due to incoming material or poor material flow ability or lack of required performance or required maintenance.
3. Loss of time, inconvenience, loss of material, down time or any other consequential damage.
4. Product use for a function that is different than designed intent.
5. LANKOTA, Inc. is not responsible for any equipment that this product is attached to or mounted on.

To activate this warranty, the purchaser must make contact in writing with LANKOTA Inc. within one (1) year of date of purchase. After contact, LANKOTA Inc. has the right to determine the cause and qualify the legitimacy of the claim. LANKOTA Inc., upon acceptance of a warranty claim, shall have a reasonable time to plan any repair or replacement and may affect repair or replacement out of its factory or through contract with a local repair service. If a purchaser after warranty notice is made, chooses to make the repair itself, LANKOTA Inc. must approve any expenses before they are incurred to be responsible for customer reimbursement. LANKOTA Inc. will not be liable for any other or further remedy including claims for personal injury, property damage or consequential damage.

#### **RETURN OF MERCHANDISE**

Merchandise may not be returned without written approval from the factory. All returns must have a return authorization number. Obtain this number before the return and show it on all return items. A 30% restocking charge is made on merchandise returned. Returned merchandise must be shipped pre-paid unless issue involves defects of materials or manufacturing.

#### **RECEIVING MERCHANDISE AND FILING CLAIMS**

When receiving merchandise it is important to check both the number of parts and their description with packing slip. The consignee must make all claims for freight damage or shortage within 10 days from the date of delivery.

When the material leaves the factory it becomes the property of the consignee. It is the responsibility of the consignee to file a claim on any possible damage or loss. Please list your preferred routing on purchase orders.

#### **MODIFICATIONS**

It is the policy of LANKOTA Inc. to improve its products whenever possible and practical to do so. We reserve the right to make changes, improvements and modifications at any time without incurring the obligation to make such changes, improvements and modifications on any equipment sold previously.



## OPERATOR QUALIFICATIONS

Operation of this Header Trailer shall be limited to competent and experienced persons. In addition, anyone who will operate or work around a Header Trailer must use good common sense. In order to be qualified, they must also know and meet all other requirements, such as:

1. Some regulations specify that no one under the age of 18 may operate power machinery. This includes equipment attached to the Header Trailer. It is your responsibility to know what these regulations are in your own area or situation.
2. Current OSHA regulations state in part: “At the time of initial assignment and at least annually thereafter, the employer shall instruct every employee or user in the safe operation and servicing of all equipment with which the employee or user is, or will be involved.”
3. Unqualified persons are to stay out of the work area as shown in the work diagrams.
4. A person who has not read and understood all operating and safety instruction is not qualified to operate the machine.

## SAFETY OVERVIEW

YOU are responsible for SAFE operation and maintenance of your LANKOTA Header Trailer.

YOU must ensure that you and anyone who is going to operate maintain, or work around the Header Trailer must be familiar with the operating, maintenance, and safety information contained in the manual. This manual will take you step by step through your working day and alerts you to all good safety practices while operating the Header Trailer.

Remember YOU are the key to safety. GOOD PRACTICES protect not only you but also the people around you. Make these practices a working part of your safety program. Be certain EVERYONE operating this machine is familiar with the procedures recommended and follows safety precautions. Remember, most accidents can be prevented. Do not risk injury or death by ignoring any information addressed.

Header Trailer owners must give operating instructions to operators before allowing them to operate the tender. They must be reviewed at least annually thereafter per OSHA regulation 1928.57.

The most important safety device on the equipment is a SAFE OPERATOR. It is the operator’s responsibility to read and understand ALL instructions in the manual and to follow them. All accidents can be avoided!

Any person who has not read and understood all operation and safety instructions is not qualified to operate the Header Trailer. An untrained operator exposes himself and bystanders to possible serious injury or death.

Do not modify the equipment in any way. Unauthorized modifications may impair the functions and/or safety and could affect the life of the equipment.



## **MACHINE INSPECTION**

After delivery of your new LANKOTA Header Trailer and/or completion of assembly, before each use, inspection of the machine is mandatory. This inspection should include, but not be limited to:

1. Check to see that all guards are in place, secured and functional.
2. Are all fasteners tight?
3. Check all grease zirks and grease if needed.

## **SAFETY DECALS**

1. Keep safety decals clear and legible at all times.
2. Replace decals and signs that are missing or have become unreadable.
3. Safety signs are available from your Dealer or the Manufacture.



## **TIRE SAFETY**

1. Failure to follow proper procedures when mounting a tire on a wheel or rim can produce an explosion which may result in serious injury or death.
2. Do not attempt to mount a tire unless you have the proper equipment and experience to do the job
3. Inflating or servicing tires can be dangerous. Whenever possible, trained personnel should be called to service and/ or mount tires.
4. Always order and install tires and wheels with appropriate capacity to meet or exceed the anticipated weight to be placed on the equipment.



## **DANGER**

Be alert to overhead obstructions and electrical wires. Failure to do so may result in electrocution. Maintain at least ten (10) feet of clearance. See chart showing the height and width of your trailer.



## **LUBRICATION & MAINTENANCE**

For economical and efficient operation of your LANKOTA Combine Header Trailer maintain regular and correct lubrication. Neglect leads to reduced efficiency, excessive wear and needless down time.

1. Grease Combine Header Trailer trolley at least once a week when using.
2. Check and grease wheel bearings as needed.

**There is only the one grease point (located on the front pivot dolly) on Lankota Header Trailers other than the wheel bearings.**

# TRAILER WIRING

## ELECTRICAL TRAILER WIRING: 7 - PIN CONNECTOR

Conntek

2122 E. Birchwood Ave. Cudahy, WI 53110 www.conntek.com

178CS334-7

ALL SPECIFICATIONS ARE SUBJECT TO CHANGE WITHOUT NOTICE.

### Trailer-7 Way Cable Diagram

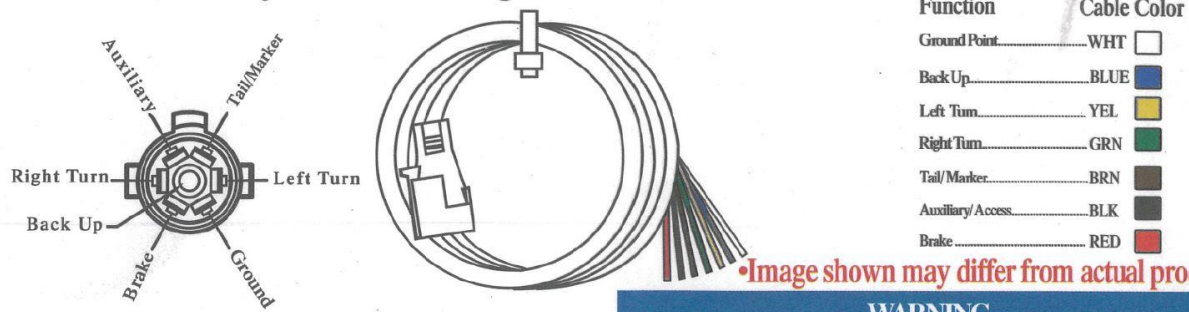

•Image shown may differ from actual product.

#### WARNING

The above Diagram is an instruction to wire vehicles for towing. Some manufacturers use a different wire setup than listed above. It is recommended that you use a test light to ascertain charges before wiring a vehicle. It is also recommended that you check with the manufacturer or dealership for vehicle specific information before you start wiring.

These instructions are for Conntek Integrated Solutions products only. It is important you READ all instructions before you attempt to wire a vehicle using Conntek Integrated Solutions products. Follow the instructions above. Improperly wiring the towed Vehicle may cause electrical malfunction or other damage, which could result in property damage, personal injury or even death.

Lankota DOT compliant header trailers are equipped with three axles. All DOT compliant Lankota header trailers come with brakes on the two rear axles as well as the front tricycle axle. **THE FRONT TRICYCLE BRAKES ARE UNHOOKED WHEN THE HEADER TRAILER LEAVES THE FACTORY.** Lankota **DOES NOT** recommend utilizing these front brakes on this tricycle design trailer. However it is mandatory under certain state regulations that the trailer be equipped as so. Lankota has provided a quick disconnect feature for hooking and unhooking this brake assembly as shown below. The pig tails can be found running along the main trailer wiring along the tricycle goose neck assembly.



## BOLT TORQUE

### TORQUE DATA FOR STANDARD NUTS, BOLTS, AND CAPSCREWS.

Tighten all bolts to torques specified in chart unless otherwise noted. Check tightness of bolts periodically, using bolt chart as guide. Replace hardware with same grade bolt.

NOTE: Unless otherwise specified, high-strength Grade 5 hex bolts are used throughout assembly of equipment.



#### Torque Specifications

**Bolt Torque for Standard bolts \***

"A"	GRADE 2		GRADE 5		GRADE 8	
	lb-ft	(N.m)	lb-ft	(N.m)	lb-ft	(N.m)
1/4"	6	(8)	9	(12)	12	(16)
5/16"	10	(13)	18	(25)	25	(35)
3/8"	20	(27)	30	(40)	45	(60)
7/16"	30	(40)	50	(70)	80	(110)
1/2"	45	(60)	75	(100)	115	(155)
9/16"	70	(95)	115	(155)	165	(220)
5/8"	95	(130)	150	(200)	225	(300)
3/4"	165	(225)	290	(390)	400	(540)
7/8"	170	(230)	320	(430)	450	(600)
1"	225	(300)	330	(440)	470	(630)

**Bolt Torque for Metric bolts \***

"A"	CLASS 8.8		CLASS 9.8		CLASS 10.9	
	lb-ft	(N.m)	lb-ft	(N.m)	lb-ft	(N.m)
6	9	(13)	10	(14)	13	(17)
7	15	(21)	18	(24)	21	(29)
8	23	(31)	25	(34)	31	(42)
10	45	(61)	50	(68)	61	(83)
12	78	(106)	88	(118)	106	(144)
14	125	(169)	140	(189)	170	(230)
16	194	(263)	216	(293)	263	(357)
18	268	(363)	--	--	364	(493)
20	378	(513)	--	--	515	(689)
22	516	(699)	--	--	702	(952)
24	654	(886)	--	--	890	(1206)

Torque figures indicated are valid for non-greased or non-oiled threads and heads unless otherwise specified. Therefore, do not grease or oil bolts or capscrews unless otherwise specified in this manual. When using locking elements, increase torque values by 5%.

\*GRADE or CLASS value for bolts and capscrews are identified by their head markings.

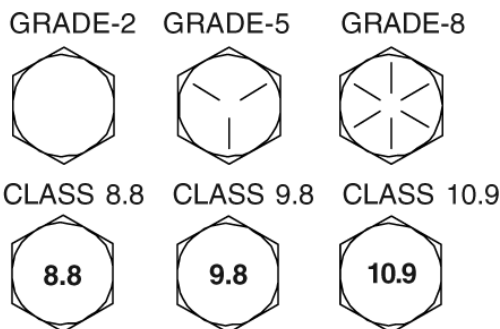
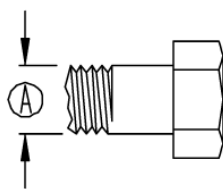



# OPERATING PROCEDURES

## STARTUP AND BREAK-IN PROCEDURES



It is essential to inspect your LANKOTA Combine Header Trailer before each day.

Make sure:

1. All bolts are tight
2. All tires have proper pressure.
3. All pins are in and all clips are in the pins.
4. All grease points are greased.

## HIGHWAY AND TRANSPORT OPERATIONS

1. Always drive at a safe speed relative to local conditions and ensure that your speed is low enough for an emergency stop to be safe and secure. Keep speed to a minimum.
2. Reduce speed prior to turns to avoid the risk of overturning.
3. Avoid sudden uphill turns on steep slopes.
4. Always keep towing vehicle in gear to provide engine braking when going downhill. Do not coast.
5. Do not drink and drive.
6. Comply with state and local laws governing highway safety and movement of farm machinery on public roads.
7. Use approved accessory lighting, flags, and necessary warning devices to protect operators of other vehicles on the highway during daylight and nighttime transport.
8. The use of flashing amber light is acceptable in most localities. However, some localities prohibit their use. Local laws should be checked for all highway lighting and marking requirements.
9. When driving the equipment on the road or highway under 20 MPH at night or during the day. Use flashing amber warning lights and slow moving vehicle (SMV) identification emblem.
10. Plan your route to avoid heavy traffic.
11. Be a safe and courteous driver. Always yield to oncoming traffic in all situations, including narrow bridges, intersections, etc.
12. Be observant of bridge load ratings. Do not cross bridges rated lower than the gross weight at which you are operating.
13. Watch for obstructions overhead and to the side while transporting.
14. Always operate equipment in a position to provide maximum visibility at all times. Make allowances for increased length and weight of the equipment when making turns, stopping the unit, etc.



## TRANSPORTING LANKOTA COMBINE HEADER TRAILER

**DANGER:** Do not transport LANKOTA Combine Header Trailer at speeds in excess of 60 MPH and comply with your state and local regulations governing marking, towing and maximum width. Observe safe driving and operation practices.