

LANTB18207

Installation Instructions

Lankota Toolbox for John Deere STS Combines (50, 60, 70 & S-Series)

LANKOTA®

270 West Park Avenue
Huron, SD 57350
866-526-5682

Numerical Parts List

Part Numbers	Description	Qty
LANTB18207BX	Assembled Toolbox	1
LANTBC13	Combine Box Weldment	1
LANTBC14	Combine Lid Weldment	1
LANTBC07	Piano Hinge	1
LAN6082A22	Draw Latch	1
REDB102	1/4" x 1/2" Hex Bolt	6
LANF03JR	1/4" x 1/2" Socket Head Bolt	6
LANEJRN	1/4" Flanged Nyloc Nut	12
LANF0B1Z	#10-24 x 3/4" Machine Screw	2
LANF0DNU	#10-24 Nyloc Nut	2
LANF0F1I	3/16" Fender Washer	2
RED-TRC-TAPE	40" of 4" Wide Traction Tape	2
CAB1610SB3-343	Edge Trim	6ft
LANTBC09	Under-Frame Support	2
LAN18A00	3/8" x 1" Hex Bolt	2
LAN18A	3/8" x 1" Carriage Bolt	4
LAN18000	3/8" Flat Washer	8
RED0DTT	3/8" Top Lock Nut	6

Pictorial Parts List

 <p>LANTB18207BX (1)</p>		 <p>LANTBC09 (2)</p>	
 <p>LAN18A00 (2)</p>	 <p>LAN18000 (8)</p>	 <p>REDD0TT (6)</p>	 <p>LAN18A (4)</p>

Kit Installation



Figure 1

Refer to Figures 1—4

1. Remove the side step from the machine. Clear the fresh edge of all dirt and debris.
2. Hang the box from the old step's holes with (4) 3/8" carriage bolts, washers and top lock nuts. Snug the hardware.



Figure 4



Figure 2



Figure 3

Kit Installation

Figure 5



Refer to Figures 5—7

3. Under the frame, remove the M16 nuts from the cross braces behind the toolbox and mount the supports (LANTBC09).
4. Set the support's notch against the cross brace plate (as shown), square it with the toolbox and tighten the nuts.
5. On S780 & S790 combines, the frame plates are different. Cut off the first notch to expose the second. Make smooth and repaint.
6. Mark the holes on the toolbox, remove it and drill them out with a 13/32" bit.
7. Reinstall the toolbox and connect the box and supports with 3/8" hex bolts and hardware.
8. Tighten all hardware.

Figure 6



Figure 7

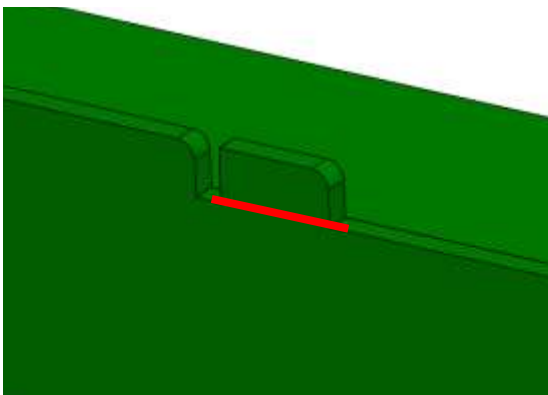

Kit Installation



Refer to Figures
Fill it with all the tools and parts you might need.



For further technical assistance,

Call Lankota Inc. at:

1-866-526-5682

